

The **digital age** of cinema is here!

DIGITAL  
PICTURE BY  
**DLP**  
CINEMA  
TEXAS INSTRUMENTS

Presenting the new range of  
**DLP Digital Cinema®** projectors  
from NEC



Empowered by Innovation

**NEC**

# DLP CINEMA®

## PROJECTORS from NEC

Welcome to the digital age of cinema!

Now, theatre managers can deliver stunning digital images to their audiences regardless of screen size, while simplifying theatre management and reducing costs. NEC offers a range of advanced digital cinema projectors for movie theatres of all sizes; the NC2500S for large screen multiplexes, the NC1600C for medium-sized movie screens and the NC800C for small theatres, screening rooms, and post-production facilities. All projectors are designed to meet DCI specifications for performance and reliability.

Why digital?

- **Stunning colour and graphics!**

NEC's digital cinema projectors deliver uncompromising brightness, sharper graphics and stunning colour, using DLP Cinema® technology from Texas Instruments.

- **Undiluted quality**

With digital reproduction there are none of the deterioration issues that can arise from reproducing film. This means your viewers see it straight from the source, just as the producers intended it to be seen.

- **Complete flexibility**

Another advantage of digital projection is its flexibility and ease of use. Managing playlists, uploading film and performing playbacks has never been easier - and they can all be controlled from anywhere in the multiplex.

# NC2500S

PROJECTORS

## The world's **BRIGHTEST** DLP Cinema® Projector

NEC's NC2500S with state of the art technology, is best suited for large theatres with screens up to 30 metres (100ft)<sup>4</sup> wide.

The world's brightest<sup>1</sup> projector designed for multiplexes with large screens up to 30 metres wide, NEC's NC2500S digital cinema projector is the world's brightest DLP Cinema® projector. Delivering precise 2K (2048 x 1080) resolution and high contrast images (2000:1), the NC2500S digital cinema projector is easy to operate, extremely user friendly, and requires minimal maintenance.



- **Easy to operate! User friendly!**
  - World's FIRST memory functions for lens position and lamp output<sup>1</sup>
  - World's FIRST lamp changes possible from back of projector<sup>1</sup>
  - Direct selection buttons for 8 stored titles
  - Projector can be controlled from an optional touch screen
  - Auto lamp brightness control
  - Standard film projector lamps can be used<sup>2</sup>
  - Built-in webserver allows basic control of the projector from any web browser
- **World's FIRST DLP Cinema Projector® for screens up to 30M**
- **Precise 2K (2048 x 1080) resolution**
- **High contrast 2000:1 images**
- **Minimal maintenance**
  - DMD shielding prevents dust, oil and smoke particles from settling on DMD surface<sup>5</sup>

### Standard Supplied Accessories<sup>7</sup>

- Remote control unit
- Cable for remote control unit (16m/629 in)
- Lens holder, to attach to NEC primary lens
- User's manual
- Power cord for projection head

(NB. DVI-D cable is not standard for NC2500/NC1600/NC800)

### NC2500S SPECIFICATIONS:

#### Light Output

26,000 Lumens<sup>8</sup>

#### Supported Screen Sizes

Up to 30m (100ft)<sup>4/5</sup>

#### Contrast Ratio

2000:1 or above (full on/off)

#### Lamp Bulbs

NEC high efficiency Xenon lamp bulbs

- NEC 4.5KW lamp bulb
- NEC 6.0KW lamp bulb

Standard film lamp bulbs<sup>2</sup>

Select according to installation conditions. NEC recommends the use of NEC lamp bulbs.

#### DMD Specifications

1.2", 12° tilt angle, 2048 x 1080 pixels

#### Primary Lenses:

1.25 to 1.45:1, 1.45 to 1.8:1, 1.8 to 2.4:1  
2.2 to 3.0:1, 3.0 to 4.3:1

#### Cooling Method

- Liquid cooling inside, air cooling with dust preventing electrostatic filter
- Total thermal dissipation: 30539BTU (Input 7KW power to NEC 6.0KW lamp bulb)
- Projector exhaust: 424CFM
- Demand of exhaust duct: 565CFM

#### Fan Noise

Less than 65 dB

#### Power Supply Voltage<sup>5</sup>

- Projector head: 200 to 240V AC, 50/60Hz, single phase
- Lamp power supply unit: 200 to 230V/380 to 415V AC, 50/60Hz, 3 phases

#### Rated Input Current

Projector head: 5A Max

Lamp power supply unit: 28A Max

#### Power Consumption

Projector head: 950W

Lamp power supply unit: 8000W

#### External dimensions

Projector head:

700 (W) x 1100 (D) x 503 (H) (mm)

*Excluding lens, lens hood and exhaust stack.*

Lamp power supply unit:

596(W) x 397(D) x 471(H) (mm)

Projector head + Pedestal (NEC Option):

700 (W) x 1100 (D) x 1367 (H) (mm)

*Excluding lens, lens hood, exhaust stack and handle. Including feet.*

#### Weight

- Projector head: Approx. 120kg / 265 lb
- Excluding lens*

• Lamp power supply unit:

• Approx. 50.5kg / 112 lb

• Projector head + Pedestal (NEC Option):

• Approx. 255.5kg / 564 lb

• Including lamp power supply unit

# NC1600C

PROJECTORS

## Integrated-type new DLP Cinema® 0.98" DC2K projector<sup>1</sup>

NEC's NC1600C Integrated-type DLP Cinema® projector houses the lamp power supply and the projector head in the same unit. Suitable for screens up to 20 metres (65ft)<sup>4</sup> wide.

For medium-sized screens, the NEC NC1600C digital cinema projector delivers high quality output and ease of operation. Managers can set lens position and lamp output using memory functions, and perform lamp changes easily from the back of projector. Other features include optional touch screen control, auto lamp brightness control, and compatibility with most standard film projector lamps<sup>2</sup>.



### ■ Easy to operate & user friendly!

- Standard memory functions for lens (zoom, position/focus) and lamp power
- Industry FIRST; lamp changes possible from back of projector<sup>1</sup>
- Direct selection buttons for 8 stored titles
- Projector can be controlled from an optional touch screen
- Auto lamp brightness control
- Standard film projector lamps can be used<sup>2</sup>
- Built-in webserver allows basic control of the projector from any web browser

### ■ Integrated-type<sup>3</sup> DLP Cinema® Projector for screens up to 20M (65ft)<sup>5</sup>

### ■ Precise 2K (2048 x 1080) resolution

### ■ High contrast 2200:1 images

### ■ Minimal maintenance

- DMD shielding prevents dust, oil and smoke particles from settling on DMD surface<sup>5</sup>

### NC1600C SPECIFICATIONS

#### Light Output

17,000 Lumens<sup>8</sup>

#### Supported Screen Sizes

Up to 20 m (65ft)<sup>4/5</sup>

#### Contrast Ratio

2200:1 or above (full on/off)

#### Lamp Bulbs

- NEC high efficiency 4.0KW Xenon lamp bulbs
  - NEC 4.0KW Xenon long life lamp bulb (option)
  - Standard film lamp bulbs<sup>2</sup>
- NEC recommends the use of NEC lamp bulbs.

#### DMD Specifications

0.98", 12° tilt angle, 2048 x 1080 pixels

#### Primary Lenses:

1.3 to 1.75:1, 1.75 to 2.4:1, 2.4 to 3.9:1

#### Cooling Method

- Liquid cooling inside, air cooling with dust preventing electrostatic filter
- Total thermal dissipation: 18767BTU (Input 4KW power to NEC 4.0KW lamp bulb)
- Projector exhaust: 150CFM
- Demand of exhaust duct: 565CFM

#### Fan Noise

Less than 63 dB

#### Power Supply Voltage

- 200 to 240V AC, 50/60Hz, single phase

#### Rated Input Current

30A MAX

#### Power Consumption

5500W(T.B.D)

#### External dimensions

Projector:

700 (W) x 990 (D) x 503 (H) (mm)

*Excluding lens, lens hood and exhaust stack.*

#### Weight

- Projector: Approx.99kg / 218 lb

*Excluding lens and handle.*

### Standard Supplied Accessories<sup>7</sup>

- Remote control unit
- Cable for remote control unit (16m /629 in)
- User's manual
- Collet for 2KW/3KW film projector lamp bulbs

(NB. DVI-D cable is not standard for NC2500/ NC1600/NC800)

# NC800C

PROJECTORS

## The world's **LIGHTEST** DLP Cinema® projector<sup>1</sup>

NEC's NC800C is a next generation compact all-in-one DLP Cinema® projector suitable for smaller screens up to 10 metres (32ft)<sup>4</sup> wide.

Perfect for screening rooms, post-production facilities and commercial cinemas with smaller screens, NEC's NC800C digital cinema projector is the world's lightest integrated digital cinema projector<sup>1</sup> for screens 4<sup>9</sup> to 10<sup>4</sup> metres wide. Using DC 2K DMD™ technology, and delivering pristine images at 2048 x 1080 pixel native resolution, the NC800C digital cinema projector exceeds Texas Instruments' guidelines for contrast ratio, colorimetry and uniformity.



■ **Easy to operate! User friendly!**

- Easy projection title selection
- Lens shift function
- Lens memory function
- Module-type compact lamp house
- Automatic lamp power control

■ **World's LIGHTEST DLP Cinema® Projector<sup>1</sup> for screens up to 10M**

■ **Precise 2K (2048 x 1080) resolution**

■ **High contrast 2000:1 images**

■ **Low maintenance**

- DMD shielding prevents dust, oil and smoke particles from settling on DMD surface<sup>5</sup>

### NC800C SPECIFICATIONS

**Light Output**

6400 Lumens<sup>8</sup>

**Supported Screen Sizes**

Up to 10m (32ft)<sup>4/5</sup>

**Contrast Ratio**

2000:1 or above (full on/off)

**Lamp Bulbs**

NEC high efficiency Xenon lamp bulbs

- NEC 1.25KW lamp bulb
- Standard film lamp bulbs cannot be used for NC800C.

**DMD Specifications**

1.2", 12° tilt angle, 2048 x 1080 pixels

**Primary Lenses:**

1.25 to 1.45:1, 1.45 to 1.8:1, 1.8 to 2.4:1, 2.2 to 3.0:1, 3.0 to 4.3:1

**Cooling Method**

- Air cooling system with dust preventing electrostatic filter
- Total thermal dissipation: 7766BTU
- Projector exhaust: 50CFM

**Fan Noise**

45 dB (when set to low brightness mode)

**Power Supply Voltage**

- 100 to 120V or 200 to 240V AC, 50/60Hz, single phase

**Rated Input Current**

12A MAX (100 to 120V)

8.5A MAX (200 to 240V)

**Power Consumption**

1200 to 1440W (100 to 120V)

1700W (200 to 240V)

**External dimensions**

Projector:

670 (W) x 752 (D) x 423 (H) (mm)

*Excluding lens, lens hood and handle.*

*Including feet. Pedestal not supplied by NEC.*

**Weight**

- Projector: Approx. 68kg / 150lb

*Excluding lens.*

*Pedestal not supplied by NEC.*

### Standard Supplied Accessories<sup>7</sup>

- Remote control unit
- Cables for remote control unit (4m/157in, 16m/629 in)
- Lens holder, to attach to NEC primary lens
- User's manual
- Power cord

(NB. DVI-D cable is not standard for NC2500/NC1600/NC800)

# Multimedia Switcher



ACCESSORIES

## The **PERFECT** companion for DLP Cinema® projectors

The NEC Multimedia Switcher converts digital data from various external sources - DVD players, PCs, digital VCRs, digital tuners and digital cameras etc - to allow DLP Cinema® projectors to screen anything from live concerts and sporting events to computer presentations and DVD content.



MM2000

### Multimedia Switcher FEATURES

#### High video quality

- Integrated Realta® video processor with HQV® (Hollywood Quality Video) technology
- 3D Motion Adaptive Deinterlacing with Multi-Directional Diagonal Filter for SD and HD
- Multi-Cadence detection including automatic detection of 2:3 /2:2 pull-down signals and many other film formats
- Per-pixel Motion Adaptive Noise Reduction for SD
- Per-pixel Detail Enhancement to bring out more visible details
- Images with high-bit depth with full 10 bit image processing for SD,HD and video sources
- High contrast images with the Contrast Enhancement function for SD-NEC Unique technology

#### Easy to operate

- One touch selection of input signals from NEC DLP Cinema Projectors
- Quick and flexible connection of input signals from up to 4 input modules



### OTHER ACCESSORIES

#### NC2500S

##### Optional Accessories<sup>7</sup>

- Pedestal for NC2500S projection head
- Lamp house module without a lamp bulb
- Touch panel controller and holder arm
- Air filter replacement
- Anamorphic lens x 1.25 and automatic anamorphic lens turret

#### NC1600C

##### Optional Accessories<sup>7</sup>

- Touch panel controller and holder arm
- Air filter replacement
- Anamorphic lens x 1.25 and automatic anamorphic lens turret



Pedestal for NC2500S & NC1600C projection head

#### NC800C

##### Optional Accessories<sup>7</sup>

- Lamp house module with a new lamp bulb
- Touch panel
- Holder arm for touch panel
- Air filter with NEC optional lamp house and lamp bulb
- Anamorphic lens x1.25 and manual anamorphic lens turret

#### Multimedia Switcher:

- **MM2000\*** - Standalone Multimedia switcher for NC800C/ NC1600C/NC2500S
- **MM2000B\*** - Built-in type Multimedia switcher for NC1600C/ NC2500S

##### Optional Accessories<sup>7</sup>

- HDSDI input board
- DVI input board
- Analogue / RGB board
- Video input board

<sup>7</sup>Standard video input x 1 and RGB analogue input x 1

## FEATURES AT A GLANCE

## GENERAL SPECIFICATIONS

PROJECTOR FEATURES	NC2500S	NC1600C	NC800C
<b>High Resolution and Contrast</b> Achieve contrast ratios of 2000:1 or higher by using DMD chips from Texas Instruments that support a resolution of 2048 x 1080 dots. Digital cinema projectors faithfully reproduce black and white digital cinema and hi-vision input sources, as well as input sources requiring superior colour reproduction and wide gradation.	✓	✓	✓
<b>One-touch Operation and Memory Functions</b> Directly select buttons for eight stored signals, plus the World's first memory functions for lens position and lamp output. Simplify display of different aspect ratios through pre-set lens shift position, zoom and focus, while maintaining constant screen brightness.	✓	✓	✓
<b>Built-in Web Server</b> Access and control digital cinema projectors from any web browser.	✓	✓	✓
<b>3D Presentation Using a Single Projector</b> Present 3D content from a single projector, eliminating the need for a costly second projector.	✓	✓	✓
<b>Auto Lamp Brightness Control</b> Set brightness from low to high, minimizing fluctuations that occur during the life of the lamp. The brightness level decreases as the lamp is consumed. The projectors optimizes lamp performance and ensure the brightness most uniform image possible for the life of lamp by automatically and gradually supplying more current to the lamp to maintain specific level of brightness as long as possible.	✓	✓	✓
<b>Minimal Maintenance</b> Benefit from custom DMD shielding that protects digital cinema projectors from dust, oil and smoke. <sup>5</sup>	✓	✓	✓
<b>Optional Touch Screen Control</b> Conveniently control digital cinema projectors from an optional touch screen.	✓	✓	✓
<b>Compatibility with Standard Film Projector Lamps</b> Use compatible third-party film projector lamps listed on NEC's website.	✓	✓	
<b>Ease of Transport</b> Especially important in rental situations, transport digital cinema projectors without having to remove the lamp bulb from the projectors.			✓
<b>Trouble-free Lamp Replacement</b> For the first time, replace lamps simply from the back of the projector even in a cramped space.	✓	✓	✓
<b>Compact Size</b> Adapt to every conceivable installation specification inside or outside a projection booth, taking advantage of NC800C digital cinema projector's compact, space-saving design.			✓

### General specifications for the NEC DLP projector range

#### Projection Method

3-chip DMD reflection method

#### DLP Cinema® Functions

CineLink™, CineCanvas™, CinePalette™, CineBlack™

#### Lens Adjustment Functions

Motorized focus, zoom, horizontal/vertical shift, light shutter (dowser)  
 Range of shift is dependent on lens.

#### Input Terminals

HDSDI port [BNC] x 2  
 DVI port [DVI-digital] x 2

#### External Controls

PC card slot (for compact flash memory card or wireless LAN card) x 1  
 LAN port [RJ-45] x 2  
 USB port [Type A] x 1  
 Serial port [RS-232C] [D-sub(9-pin)] x 1  
 General Purpose I/O [D-sub (37-pin)] x 1  
 Remote control connector x 1

#### Environment

Operational temperatures: 10°C to 35°C (41°F to 95°F), humidity: 10% to 80% (non-condensing)  
 Storage temperatures: -10°C to 50°C (14°F to 122°F), humidity: 10% to 80% (non-condensing)

#### Regulations

USA: UL60950 FCC Class A  
 Canada: CSA60950 ICES-003 Class A  
 Europe: EN60950 EN55022 1998, Class A EN55024-1998 EN61000-3-2 EN61000-3-3  
 Oceania: EN60950 AS/NZS 3548 Class A 1995 + A 1/2:1997  
 Japan: J60950 VCCI Class A  
 Asia: EN60950 CISPR Pub22

#### KEY:

- 1 Among DLP Cinema® projectors, according to a survey conducted by NEC in June 2007
- 2 Compatible third-party film projector lamps are listed on NEC's website.
- 3 "Integrated-type" means projector head and lamp power supply unit are integrated in the projector.
- 4 This can be achieved under the below installation conditions
  - 1) At screen gain 1.8/14ft-l
  - 2) Use NEC 6.0Kw lamp bulb for NC2500S and NEC high efficiency 4.0kw lamp bulb for NC1600C
- 5 Subject to installation conditions.
- 6 Power cord for projection head supplied with NC2500S. Power cord for lamp power supply unit not supplied with NC2500S. Procurement for this cable is required by exhibitors.
- 7 Standard supplied accessories and optional accessories are subject to change without notice.
- 8 Center Lumens
- 9 At screen gain 1.3/14ft-l

The **digital age** of cinema has arrived with the pioneering range of NEC Digital Light Processing (DLP) Cinema® projectors



### NC2500S external dimensions

Projector head:

700 (W) x 1100 (D) x 503 (H) (mm)

*Excluding lens, lens hood and exhaust stack.*

Lamp power supply unit:

596(W) x 397(D) x 471(H) (mm)

Projector head + Pedestal (NEC Option):

700 (W) x 1100 (D) x 1367 (H) (mm)

*Excluding lens, lens hood, exhaust stack and handle. Including feet.*

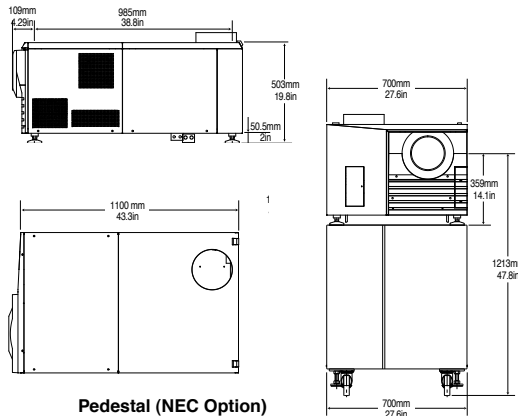

**Pedestal (NEC Option)**

\* Lamp power supply unit can be installed in the Pedestal

### NC1600C external dimensions

Projector:

700 (W) x 990 (D) x 503 (H) (mm)

*Excluding lens, lens hood and exhaust pipe.*

*Including feet.*

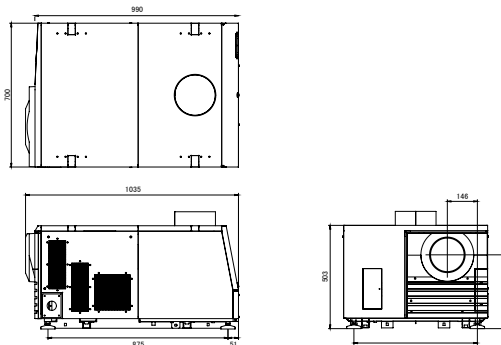

### NC800C External dimensions

Projector:

670 (W) x 752 (D) x 423 (H) (mm)

*Excluding lens, lens hood and handle.*

*Including feet.*

*Pedestal not supplied by NEC.*

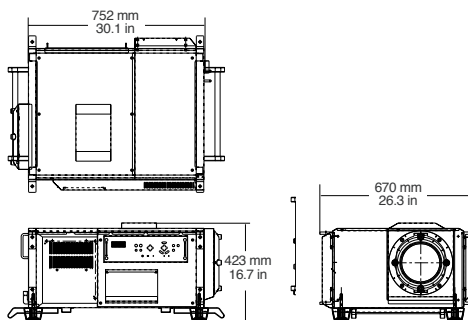

### NEC European offices:

NEC Display Solutions Germany:  
Landshuter Allee 12-14  
D-80637 München  
Germany

**T: +49-(0)89-99-699-100**  
**F: +49-(0)89-99-699-512**  
**www.nec-display-solutions.com**

NEC France:  
56 rue des Hautes  
Patures  
92024 Nanterre Cedex  
France

**T: +33-1-4649-4649**  
**F: +33-1-4649-4620**  
**www.nec.fr**

NEC Italy:  
Via Leonardo Da Vinci  
97-20090

Trezzano sul Naviglio  
Milano  
Italy

**T: +39-02-484151**  
**F: +39-02-48400875**  
**www.nec.it**

NEC Scandinavia:  
Kronborgsgraend 11  
Floor 3  
SE-164 46 KISTA  
Sweden

**T: +46-8-635-9200**  
**F: +46-8-635-9350**  
**www.nec.se**

NEC Iberica:  
Anabel Segura 7  
Planta 2  
28108 Alcobendas  
Madrid  
Spain

**T: +34-91-203-29-00**  
**F: +34-91-650-11-00**  
**www.nec.es**

NEC (UK) Ltd.  
NEC House,  
1 Victoria Road London,  
W3 6BL  
United Kingdom

**T: +44(0)845 234 4040**  
**www.nec.co.uk**

**email:**  
**visualcommunication@uk.necur.com**

©Copyright NEC (UK) Ltd. 2007  
NEC Terms & Conditions can be viewed at [www.nec.co.uk](http://www.nec.co.uk)  
DLP, DLP Cinema and their respective logos are trademarks or registered trademarks of Texas Instruments.  
CineLink, CineCanvas, CinePalette and CineBlack are trademarks of Texas Instruments.  
HQV is a registered trademark of Silicon Optix Inc. in the U.S.A., Japan, Taiwan, Korea, Australia, Mexico, Turkey, Austria, Belgium, Cyprus, Czech Republic, Denmark, Estonia, Finland, France, Germany, Greece, Hungary, Ireland, Italy, Latvia, Lithuania, Luxembourg, Malta, Poland, Portugal, Slovakia, Slovenia, Spain, Sweden, The Netherlands and The United Kingdom.  
Realta is a registered trademark of Silicon Optix Inc. in the U.S.A.  
All other trademarks are the property of their respective owners.  
Specifications are subject to change without prior notice.



Empowered by Innovation

